

KINGDOM VISION



Crosswoods Baptist Church
CrosswoodsBaptistChurch.org





A CHALLENGE OF FAITH

FROM OUR PASTOR



Dear Friends,

Crosswoods Baptist sits in a very strategic location to carry out the Great Commission that Jesus gave to the disciples first, but still expects us to carry out today. The fruits of our labor for the Kingdom of God have been evident this year as we have seen worship attendance of 210. Our children and youth activities are making an impact on lives as some have felt the call to ministry, rededications, and salvations. God has been preparing us for this very moment over the life of this church. It is an exciting time in the life of Crosswoods Baptist Church as we set out together to reach our community and the world with the gospel of Jesus Christ.

*Crosswoods Baptist Church exists to glorify God by leading people to Jesus Christ and making disciples! It is a simple statement but a very daunting task that takes commitment, desire, obedience, passion, and teamwork. In order to accomplish this great task, we must have a Kingdom Vision. Without Kingdom Vision, CBC loses its sense of mission, purpose, and direction to glorify God by carrying out the Great Commission. What does it mean to have Kingdom Vision? The biblical definition of vision does not mean having a clear mission statement or goal, rather the word refers to a revelation from God. This expansion is a clear revelation from God to enable Crosswoods Baptist to expand the Kingdom of God by reaching our community and the world with a message of hope, peace, and joy (the gospel of Jesus Christ). The time is now as our education and fellowship space is at capacity and the lack of space inhibits us from reaching more people for Christ. A Kingdom Vision requires each one of us to do several things: **COMMIT, BELIEVE AND SHARE THE GOSPEL WITH THE COMMUNITY.***

God is asking you to partner with Him in His Kingdom Vision for CBC. I urge you to join me in making a generous, worthy, and sacrificial gift over the next three years as we expand our facilities to glorify God and enable Crosswoods Baptist Church to do a greater work. God will not lead you to do anything He will not enable you to fulfill! How richly you will be blessed as you discover the Kingdom Vision as you commit and believe to reach our community for Jesus.



- Pastor Stephen Bruce

"But seek ye first the kingdom of God and His righteousness, and all these things shall be added to you." - Matthew 6:33

CALLED TO COMMIT

THEN AND NOW

The KINGDOM VISION that has been given to us will not be easy to accomplish. We need each one of you to commit yourself to obeying and following the will of God for CBC.

The members of CBC have always committed themselves to doing the will of God. It was 39 years ago that about 40 people committed to starting a church by meeting in a barn first, in order to reach this part of Jessamine County with the gospel. It was 16 years ago that the members committed to expanding their facilities so that they could continue to impact the lives of people for eternity. Neither one of these moves was easy, but you were committed and obedient to the vision God had given you. Today, the world needs the hope of the gospel worse than ever. God has called us to be the light in the world and we too need to expand so that we can continue to share the hope of the world, Jesus Christ.



THE HERITAGE OF CBC

1998 ▶
Ground Breaking of Current
Building; 300 Members

◀ **1999**
Hands-On Communion
Heaven's Hammers
Steeple Added

◀ **1996**
Claiming of Land Walk

1979 ▶
Merriman Building
Completed

◀ **1978**
Called 1st Full-Time Pastor
& Gathered in a Farm House

1976 ▶
35 People Gathered
in a Horse Barn

*"Therefore, my beloved brothers,
be steadfast, immovable, always
abounding in the work of the
Lord, knowing that in the Lord
your labor is not in vain."
- 1 Corinthians 15:58*

COMMIT

IF WE BELIEVE

HE WILL PROVIDE

This might be the hardest thing for people to do. We are not believing in just ourselves. We are believing in the revelation that God has given us to continue to do His work. Throughout scripture, God asks His people to do big things. He does not always give them all the details, but He does ask them every time to believe and be obedient. He promises them that He will provide whatever is necessary for the work to be successful. God asks that they believe He will provide and be obedient to follow His plan. CBC believed when they started this church and moved into the Merriman Building and God provided. You believed when it was time to build this building and God provided in multiple ways that were not known at the time. He provided financial resources from an estate of a non-member. He provided workers that came and had the church under roof in one week. He provided volunteers that enabled the building we worship in today to be completed. It all started with you believing in God and the vision He had given.

*"That which we have seen
and heard we proclaim also
to you, so that you too may
have fellowship with us;
and indeed our fellowship
is with the Father and
with his Son Jesus Christ."
- 1 John 1:3*

OUR GREATEST CHALLENGE: SPACE

- Space has inhibited church attendance to grow within the last 10 years.
- Current building capacity has been maximized, but now limits future growth.

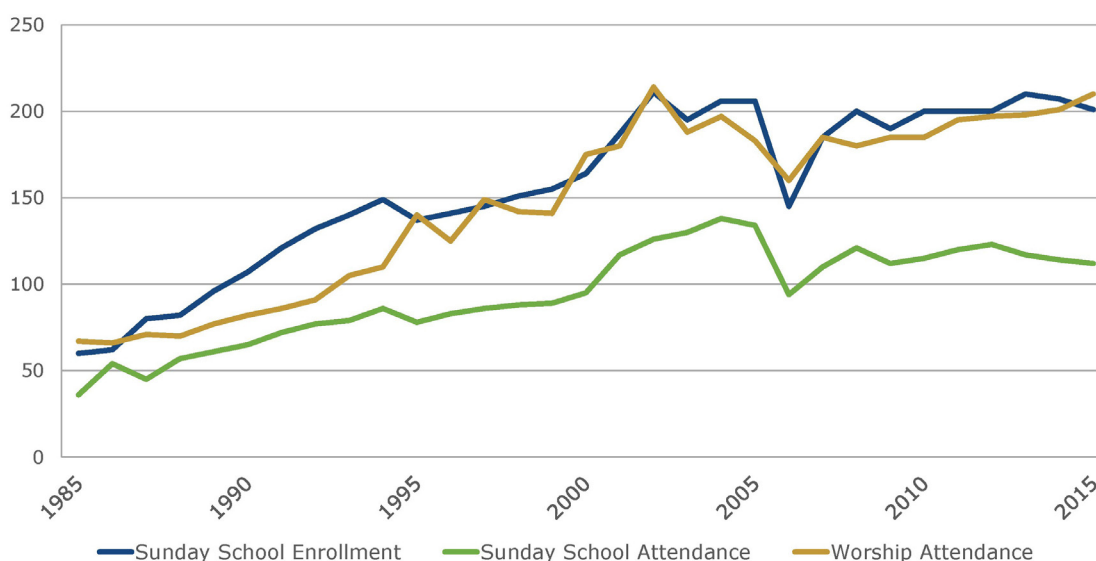

BELIEVE

SHARE WITH OUR COMMUNITY

HIS MESSAGE

The people that do not know Jesus Christ as their personal Savior is the reason we must expand. One of our missions at CBC is to glorify God by proclaiming the gospel to our community and the world. The Kingdom of God for us starts in our community. Jesus commanded the disciples to reach their community and then the surrounding areas with the gospel, Mark 16:1. God has placed us in this strategic location so that we can share with them the message of hope and peace. God wants to use you to make an eternal difference in the lives of those that live in this community.

There are many ways we could use the new space to support our current members and as outreach to the community.

FELLOWSHIP & OUTREACH OPPORTUNITIES

- Fantastic Fellowship Kitchen
- Church League Games
- Fitness Classes
- Life Recovery Groups
- Moms Day Out
- Additional Workshops
- Connect Group
- Operation Christmas Child
- Clothing Drives
- Community Holiday Meals
- Movie and Game nights
- After-School Tutor Program
- Youth Café



What is your Kingdom Vision?
Morgan shares his...

My Kingdom Vision

MORGAN POWER

Youth Worship Band



This is going to be a big step forward in the growth of Crosswoods, not just for the church as a whole, but especially for our youth.

Having recently accepted my calling into worship ministry, I can see many uses for the additional spaces. This could include so many things...but my vision is youth led worship services with uplifting music, student-gearred messages, and youth fellowship. These opportunities will allow the youth to invite a multitude of family and friends who may or may not know Christ.

We have many possibilities in front of us that we need to be actively involved with. After-all, our youth is the future and we are ready to grow in faith and ministry."

PROPOSED BUILDING PLANS

Project Highlights

EDUCATIONAL CENTER

(5,325 sq ft)

- 6 Classrooms
- Large Meeting Room
- Bathrooms

FAMILY LIFE CENTER

(9,900 sq ft)

- Gymnasium
- Kitchen & Pantry
- Storage
- Exercise Room

ESTIMATED COST

\$1.6 Million

Based on shown floor plans, as prepared by architect, Jerry W. Herndon.

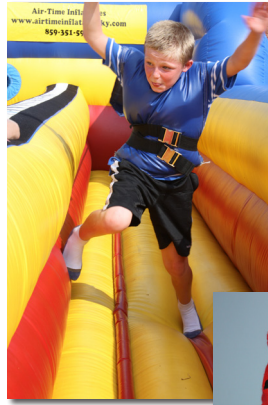

← Merriman Building

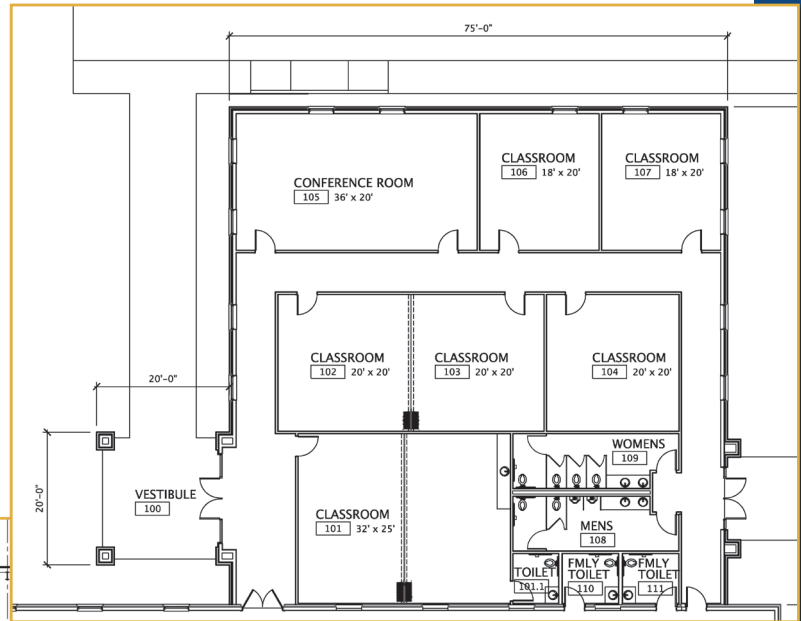

→ Current Church Building

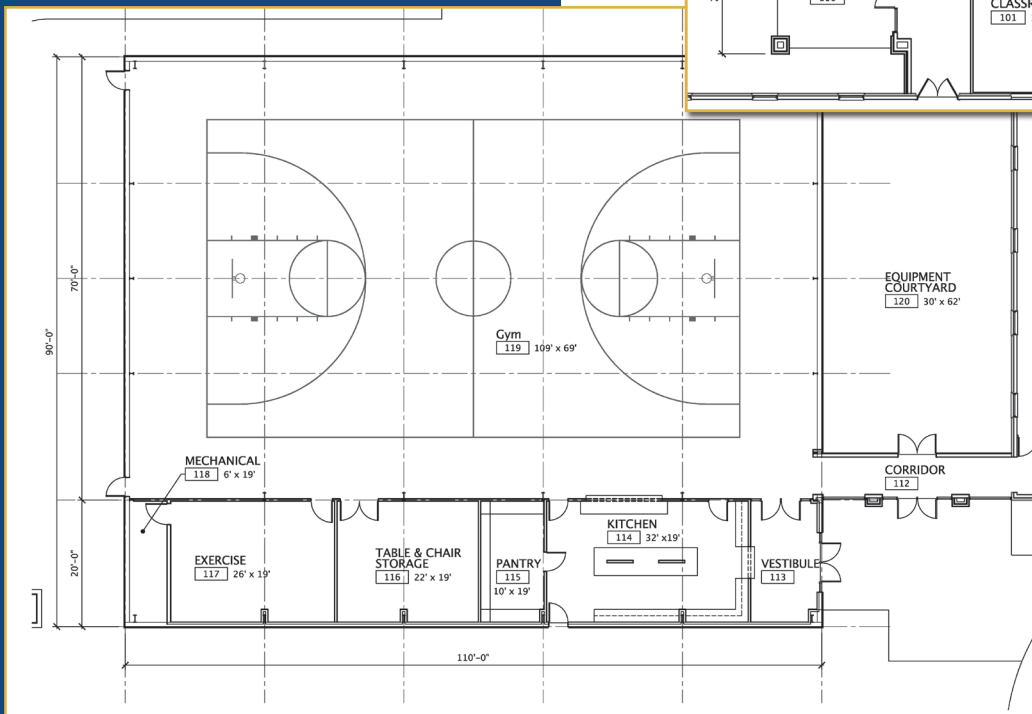

"Every good gift and every perfect gift is from above, coming down from the Father of lights with whom there is no variation or shadow due to change." - James 1:17

POWER THROUGH PARTICIPATION

Coming together as a church through our shared faith in Christ and His Great Commission is more important than ever. No goal is too great if we seek Him with our hearts, surrender to obedience, and serve with our actions. **The gifts for this project will come from giving above regular tithing.**

The chart below demonstrates the power of giving over 3 years with just 145 participants across various tiers.

Tier	Number of Participants in Tier	INDIVIDUAL Weekly Giving	INDIVIDUAL Annual Giving	INDIVIDUAL 3 Year Giving	TIER'S TOTAL 3 Year Giving
Tier 1	5	\$250	\$12,000	\$36,000	\$180,000
Tier 2	10	\$125	\$6,000	\$18,000	\$180,000
Tier 3	10	\$100	\$4,800	\$14,400	\$144,000
Tier 4	15	\$75	\$3,600	\$10,800	\$162,000
Tier 5	15	\$50	\$2,400	\$7,200	\$108,000
Tier 6	25	\$40	\$1,920	\$5,760	\$144,000
Tier 7	15	\$25	\$1,200	\$3,600	\$54,000
Tier 8	30	\$15	\$720	\$2,160	\$64,800
Tier 9	20	\$10	\$480	\$1,440	\$28,800

Total Giving After 3 Years: **\$1,065,000**

My Kingdom Vision

BARBARA CORNETT
Outreach Meals

"A new fellowship hall will make it easier to serve the less fortunate in our area.

I think it's important that everyone experience a sit down dinner with a white tablecloth. This simple act of service can show the community we value everyone."



GIVING

QUESTIONS & ANSWERS

Q: Will my family be asked to make a public commitment?

A: No, a commitment card will be provided from the church. After families have filled out their commitment cards and returned them to the church, they'll be tabulated by those authorized to tabulate all commitments.

Q: How will my family give its commitment?

A: During our Harvest Offering we will be having our special One-Time Sacrificial Gift and Commitment Sunday in which we are asking families to bring a one-time sacrificial gift and return their three year Commitment Pledge Card. The church will provide each family with envelopes that will allow them to make ongoing contributions as well as on-line giving options.

Q: How important is the One-Time Sacrificial Gift?

A: The one time sacrificial gift will allow the church to begin construction this spring and allow the project to continue with limited interruptions. It is one of the greatest Biblical convictions that Christ will always honor and reward, that which is made in His name, for His work.

Q: If my circumstances change, can I change my commitment?

A: Yes. Because the future is always uncertain, some of us will be blessed in ways that will allow us to give even more than we are committing at the present time. Others may find it necessary to lower or even cancel their commitments due to unforeseen circumstances.

Q: What are some ways I can contribute to the Kingdom Vision Campaign?

A: There are many ways to contribute: Prayer, Volunteer Services, Above Tithe Cash Gifts, Bequest Gifts, Gifts of Stocks and Bonds, Charitable IRA Roll-overs, Gifts of Real Estate, Gifts of Life Insurance, Gifts of U.S. Savings Bonds, Gifts of Tangible Personal Property, and Beneficiary Designation.



Continuing the mission of Serving Our Savior...



CrosswoodsBaptistChurch.org